

DRAGON 400KW



EPS-01_040 DRAGON 400 KW
12/17/2024

EQUIPMENT AND SUPPORT IN EVERY SHALE PLAY



DRAGON 400 KW OIL & GAS INDUSTRY GENERATORS ARE DESIGNED TO MEET THE RUGGED DEMANDS OF THE OIL & GAS INDUSTRY ENVIRONMENT, FROM EXPLORATION TO PRODUCTION. EACH MODEL HAS BEEN DESIGNED TO PROVIDE RELIABLE CONTINUOUS POWER FOR TYPICAL OIL & GAS INDUSTRY ELECTRICAL LOADS. ALL MODELS ARE EXTENSIVELY TESTED TO ENSURE THEY MEET THE PERFORMANCE REQUIREMENTS OF THE INDUSTRY. DRAGON GENERATORS ARE PACKAGED IN OUR PURPOSE-BUILT GENERATOR ASSEMBLY AND TEST FACILITY. EACH SET GOES THROUGH A FULLY DOCUMENTED TEST PROCEDURE BEFORE LEAVING OUR PLANT. DRAGON MODELS UTILIZE THE PSI NATURAL GAS ENGINES GOVERNED TO RUN AT 1800 RPM FOR LONG LIFE AND DURABILITY. ALL OIL & GAS INDUSTRY GENERATORS ARE DESIGNED AND PACKAGED AS PRIME POWER RATED SETS. SEE RATING BELOW FOR PRIME POWER KW.



GET A QUOTE

major.tennison@modernusa.com | 904.400.4984
steve.stump@modernusa.com | 614.571.1952
kreg.sorsoleil@modernusa.com | 281-705-4609
800.231.8198 | dragonproducts.com

DRAGON 400KW

STANDARD FEATURES

GENERAL UNIT DESCRIPTION:

- OIL MAKEUP TANK - 16 GALLON KENCO
- AIR FILTER SYSTEM - SINGLE STAGE REPLACEABLE FILTER
- GAS TREATMENT - SCRUBBER
- DUAL FUEL - LPG, NG, WELLHEAD NG COMPATIBLE WITH AUTO SWITCH
- EXHAUST SYSTEM - DUAL: CATALYST AND USFS SPARK ARRESTOR
- LUBRICATION - MURPHY/KENCO OIL REPLENISHMENT
- SAFETY SHUTDOWN - LOW OIL PRESSURE; LOW COOLANT LEVEL, HIGH OIL TEMP

ENGINE ELECTRICAL SYSTEM

- STARTING MOTOR VOLTAGE: 24DCV
- CHARGER AMPS: 45
- BATTERY AMPERE HOURS: 200AH/1000CCA

ENGINE SPECIFICATION

- MANUFACTURER: PSI
- MODEL: D21.9L
- EMISSIONS: US EPA CERTIFIED
- ENGINE SPEED (RPM): 1800
- MAX. HP POWER 1800 RPM: 684 ISO3046
- CYLINDER ARRANGEMENT: V-12
- COMBUSTION SYSTEM: STOICHIOMETRIC
- ASPIRATION: TURBOCHARGED
- ENGINE TYPE: DIESEL DERIVATIVE
- FUEL: NATURAL GAS/LPG
- NUMBER OF CYLINDERS: 12
- DISPLACEMENT IN3 (LITERS): 21.9
- BORE & STROKE INCHES (MM): 5.04X5.59
- COOLING: COIL AND TUBE
- STARTING AIDS: NONE
- COMPRESSION RATIO: 10.5:1
- AIR CLEANER TYPE: DRY
- EXHAUST SILENCER DBA: USFA ARRESTOR
- FUEL SWITCH: AUTOMATIC

CONTROL PANEL

THE DGC-2020HD IS EQUIPPED WITH A PROVEN GENERATOR DIGITAL CONTROLLER FOR RUGGED ENVIRONMENTS SUCH AS C&I APPLICATIONS, DRILL PLATFORMS, PUMP JACK SITES, AND LANDFILLS. THE PREMIUM CONTROL BOX HAS THE CAPABILITY TO CONTROL THE GENERATOR SET MANUALLY, REMOTELY OR AUTOMATICALLY.

- NFPA-110 COMPLIANT
- USER FRIENDLY, FULLY-CONFIGURABLE, PROGRAMMABLE, MICROPROCESSOR-BASED LOGIC CONTROLLER
- OFF-LINE SIMULATOR BEST LOGIC HELPS IDENTIFY AND TROUBLESHOOT THE LOGIC
- HIGH-CONTRAST DISPLAY IS EASY TO USE

LUBRICATING SYSTEM

- TOTAL LUBRICATING CAPACITY QUARTS (LITER): 42.25/40
- RECOMMENDED LUBRICATING OIL GRADE: SAE 15W-40
- OIL PRESSURE MINIMUM 1800RPM- PSI (BARS): 43.5/3
- MAX. ALLOWABLE OIL TEMP F (C): 250/121

COOLING SYSTEM FOR OPERATING AT 120° AMBIENT

- COOLING SYSTEM: RADIATOR CAC COMBO
- ENGINE COOLANT CAPACITY QUARTS (LITERS): 50.1 GALLON
- FAN: PUSHER
- RADIATOR: PSI
- COOLING AIRFLOW: 40,000

ARRANGEMENT

- COUPLING: FLEXIBLE
- ENCLOSURE: YES
- BASE ARRANGEMENT: GENERATOR & CONTAINMENT
- SPILL CONTAINMENT: 110%

OPTIONAL EQUIPMENT

- BLOCK HEATER: KIM HOTSTART 6000W; 7.2A; 480V
- COLD WEATHER OPTIONS: CCV, FUEL TRAIN

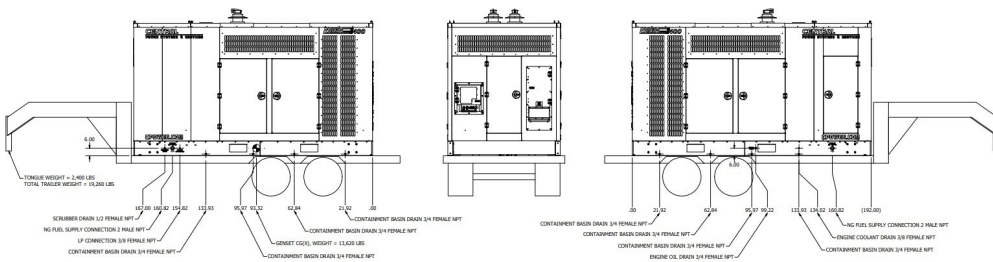

FUEL DATA:

GENERATOR SET ENCLOSURE DIMENSIONS:

POWER RATINGS	STANDBY	PRIME
GASHOUSE FUEL	KW KVA AMP	KW KVA AMP
LPG	315 394 474A	266 333 401A
NATURAL GAS (NG)	444 555 686A	390 488 587A
AMPERAGE	@480V	@480V

TYPE	CONSUMPTIONS (CU. FT/HOUR)	LENGTH	WIDTH	HEIGHT	WEIGHT LBS	DBA
NATURAL GAS/LPG	4230 NG (1480 LPG)	192"	90.5"	117.75" 9.8'	14,540 DRY	86



GET A QUOTE

major.tennison@modernusa.com | 904.400.4984
 steve.stump@modernusa.com | 614.571.1952
 kreg.sorsoleil@modernusa.com | 281-705-4609
 800.231.8198 | dragonproducts.com